

Dot Laser Kit for LineLazer™ V 3900, 5900, & 200HS HP Automatic Series & 200HS Reflective Series, and LineLazer™ 250DC & 250SPS Line Striping Systems

3A3478B

EN

Kit Number 25A530 for use on LineLazer™ V 3900, 5900 & 200HS HP Automatic Series and 200HS HP Reflective Series
 Kit Number 25A691 for use on LineLazer™ 250DC and 250SPS



*For installation of the green dot laser on LineLazer™ V airless line striping systems.
 For professional use only.*



Important Safety Instructions

Read all warnings and instructions in this manual and in related manuals.
 Be familiar with the controls and the proper usage of the equipment.
 Save these instructions.

Related Manuals:	
3A3388	LLV 3900/5900 Operation
3A3426	LLV 200HS Operation
3A3393	LLV 250SPS and 250DC Operation
1700-0041	GL1700 - Owner's Manual - Operation Guide

				
LASER LIGHT HAZARD: AVOID DIRECT EYE CONTACT				
Eye exposure to Class IIIa/3R levels of laser light can potentially present an eye (retinal) injury hazard, including spot blindness or other retinal injury. Refer to laser warnings in operation manual.				

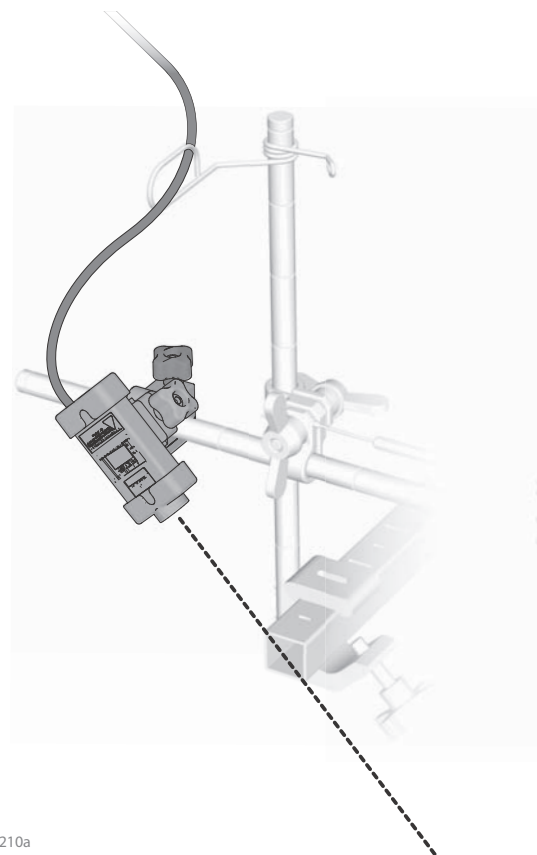

ti28210a



LineLazer V 3900, 5900 & 200HS Models

1. Remove battery cover.

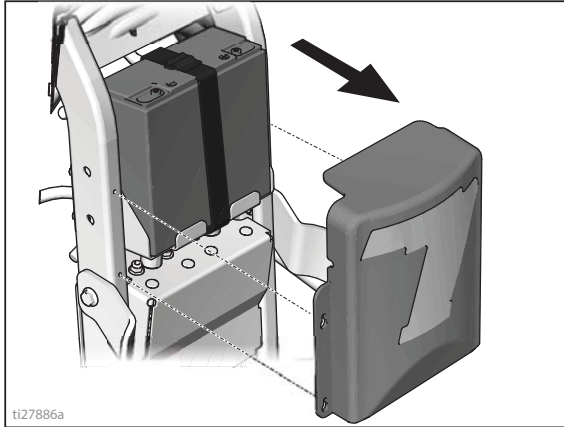

2. Attach ON/OFF switch to desired location on the handle bar.

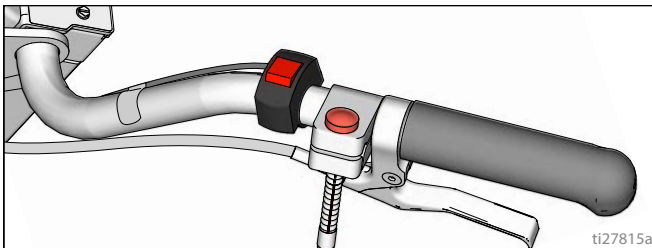

3. Attach laser to desired location on the gun arm.

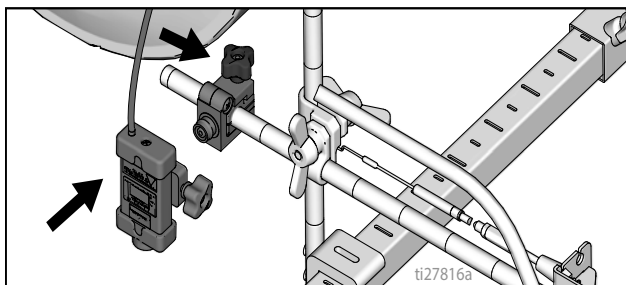

4. Route wires up to the battery and connect to the (+) and (-) terminals.

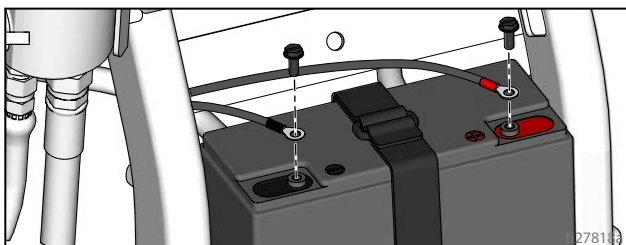

NOTICE

Do not connect GL1700 directly to a generator source as it can create over voltage and damage to the electronics.

5. Connect the switch leads to the laser wire harness.

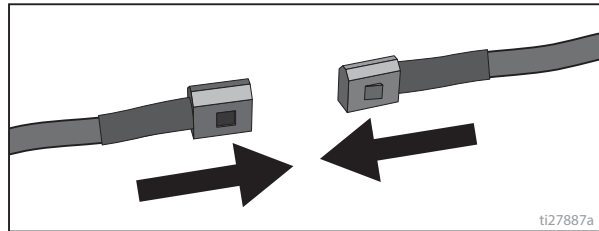

6. Reattach battery cover.

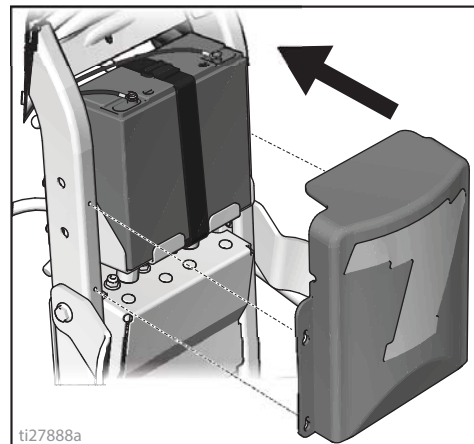

7. Turn on laser and position dot underneath gun head.

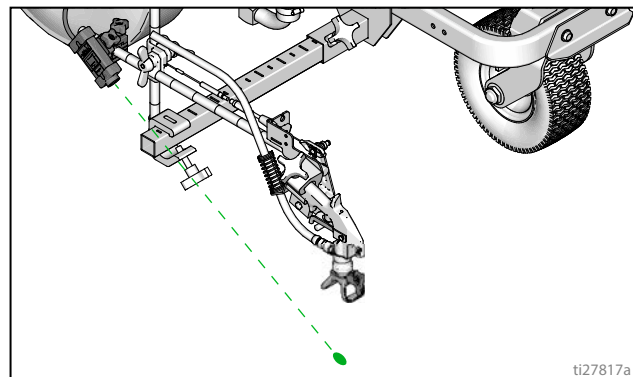

Parts

25A530

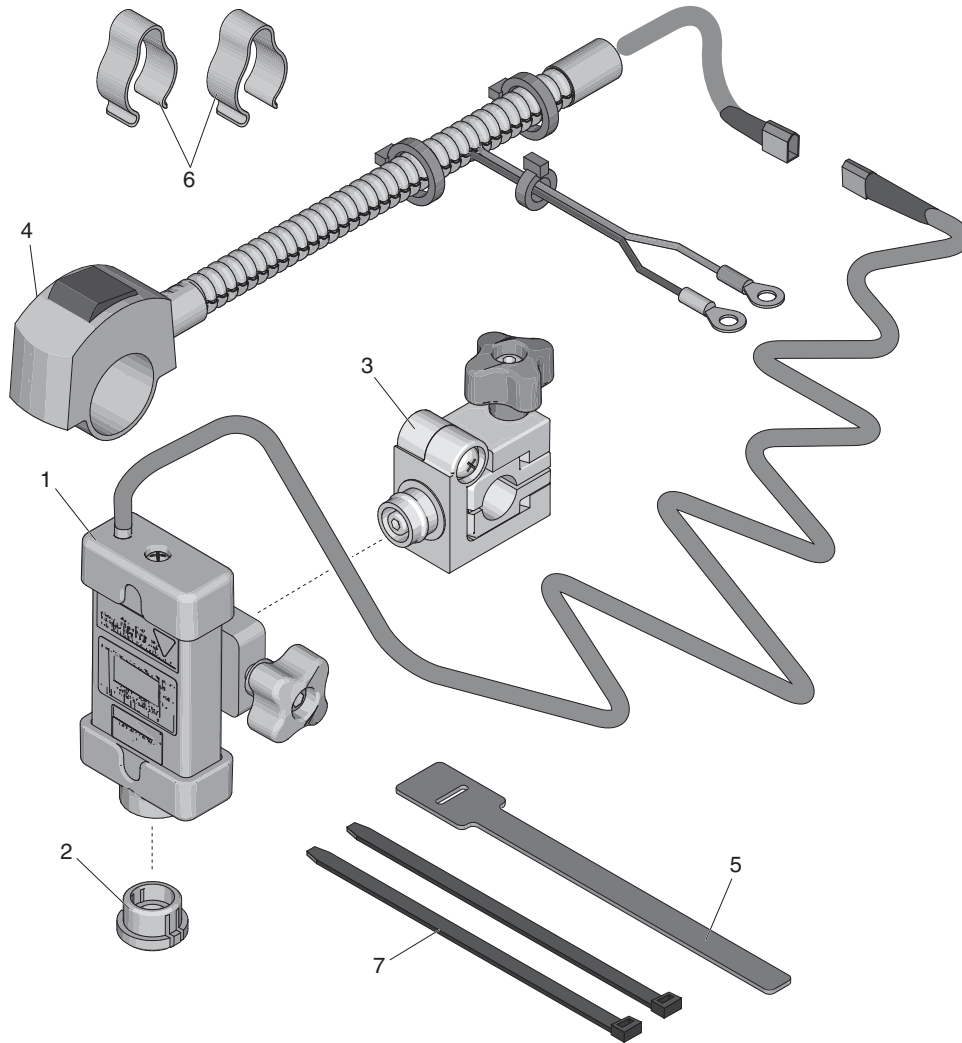

ti28268a

Ref	Part	Description	Qty	Ref	Part	Description	Qty
1	17H714	MODULE, laser, green dot	1	4	17H713	SWITCH, on/off, laser module	1
	128857*	FUSE, blade, mini, 3 amp	1	5	128854	STRAP, cable, velcro	1
	128914	MANUAL, operations, laser	1	6	178342	CLIP, spring	2
	128915	CARD, operator, laser	1	7	404989	STRAP, tie	2
	128916	LABEL, operations, laser light	1			<i>*Series A Kit only</i>	
2	128917	SHIELD, paint, laser, assy.	1			<i>Series A uses an external in-line fuse</i>	
3	128865	BRACKET, mounting, laser, assy.	1			<i>Series B uses an internal self-resetting fuse</i>	

LineLazer 250SPS & 250DC

1. Lower platform.

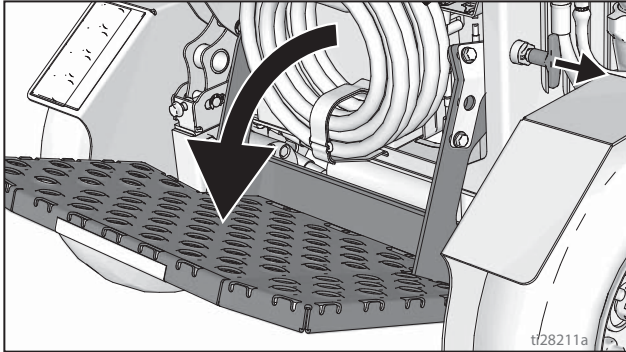

2. Remove coiled hose.

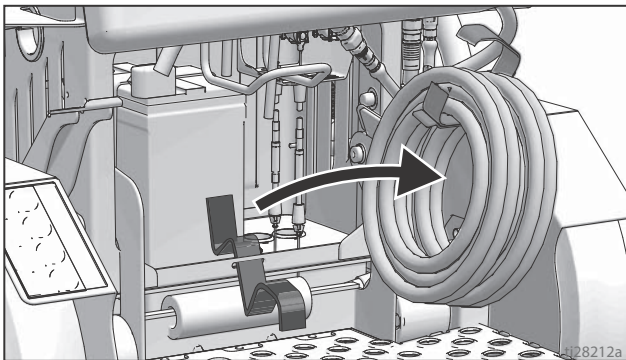

3. Remove battery.

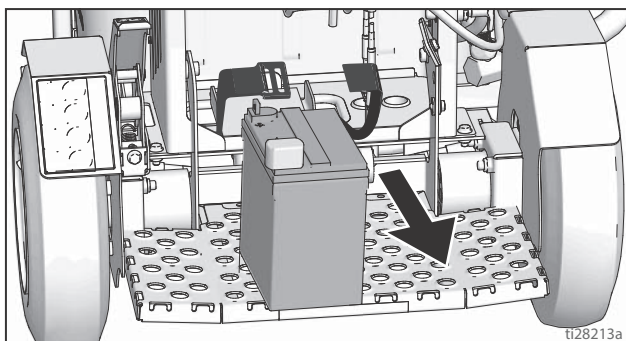

4. Attach ON/OFF switch on right side of handlebar and connect jumper.

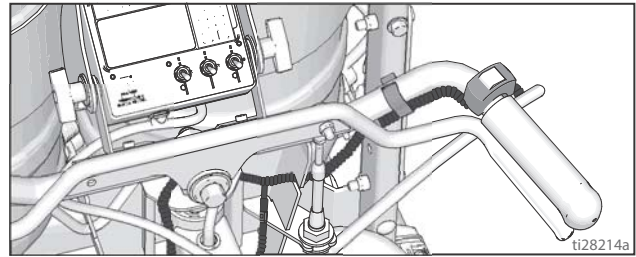

5. Route switch wiring between piston and square tube, and down to battery.

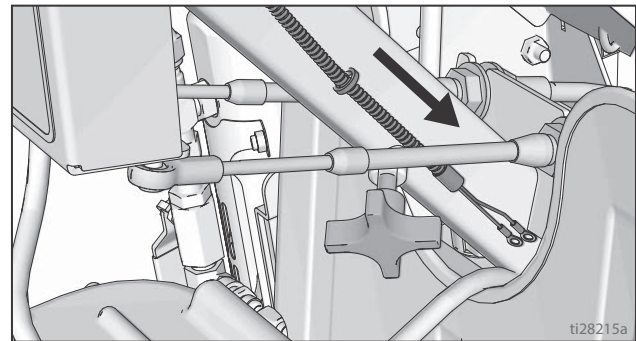

6. Route jumper between piston and square tube, and down to gun cable hole.

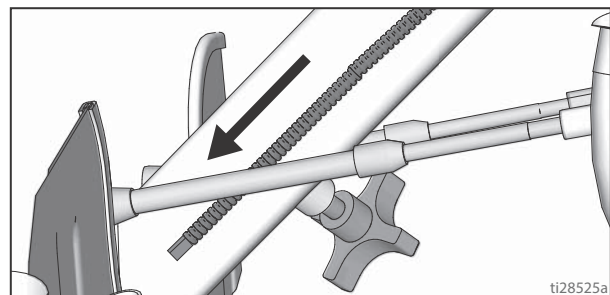

7. Secure switch wiring and jumper using cable tie.

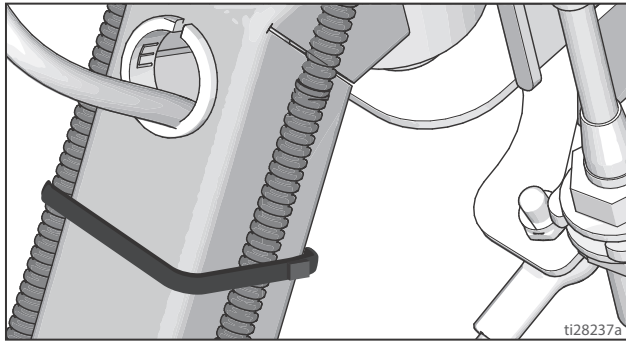

8. Attached laser to desired location on gun arm.

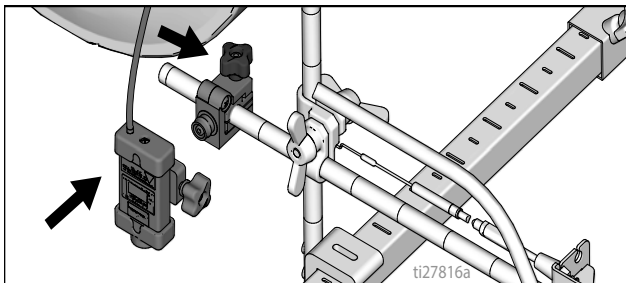

9. Route switch wires down to battery and connect to the (+) and (-) terminals, and route jumper through gun cable hole.

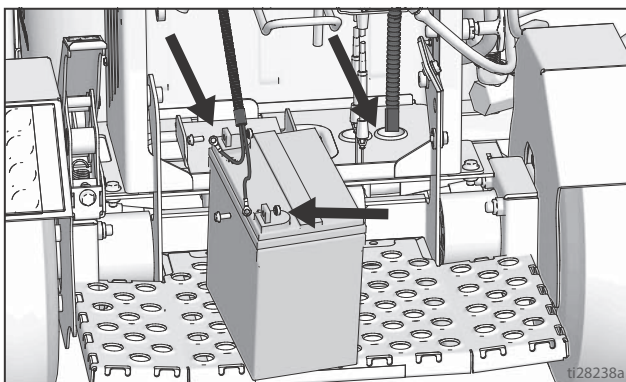

NOTICE

Do not connect GL1700 directly to a generator source as it can create over voltage and damage to the electronics.

10. Connect the jumper to the laser wire harness, and secure all cables as necessary.

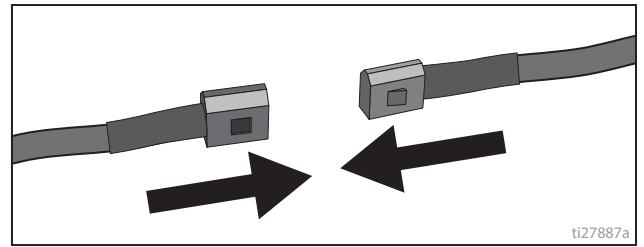

11. Reinstall the battery.

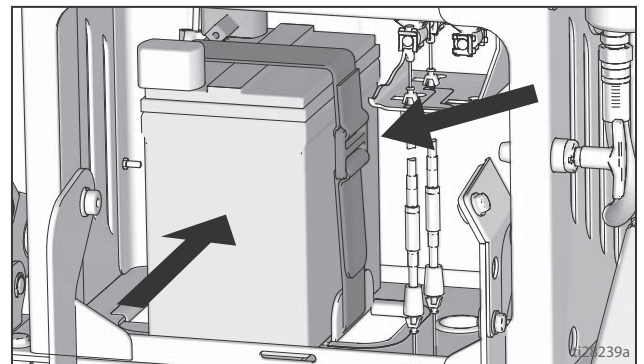

12. Replace the coiled hose.

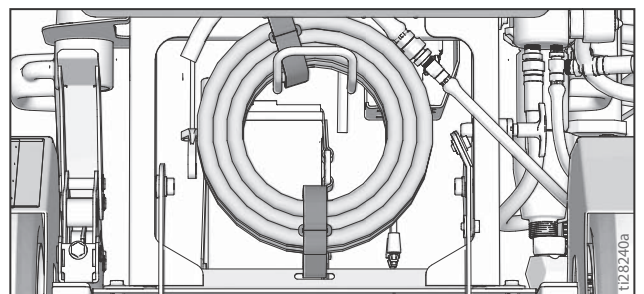

13. Turn on laser and position dot underneath gun head.

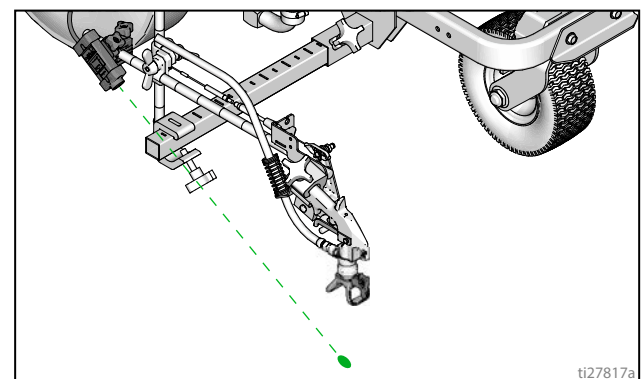

Parts

25A691

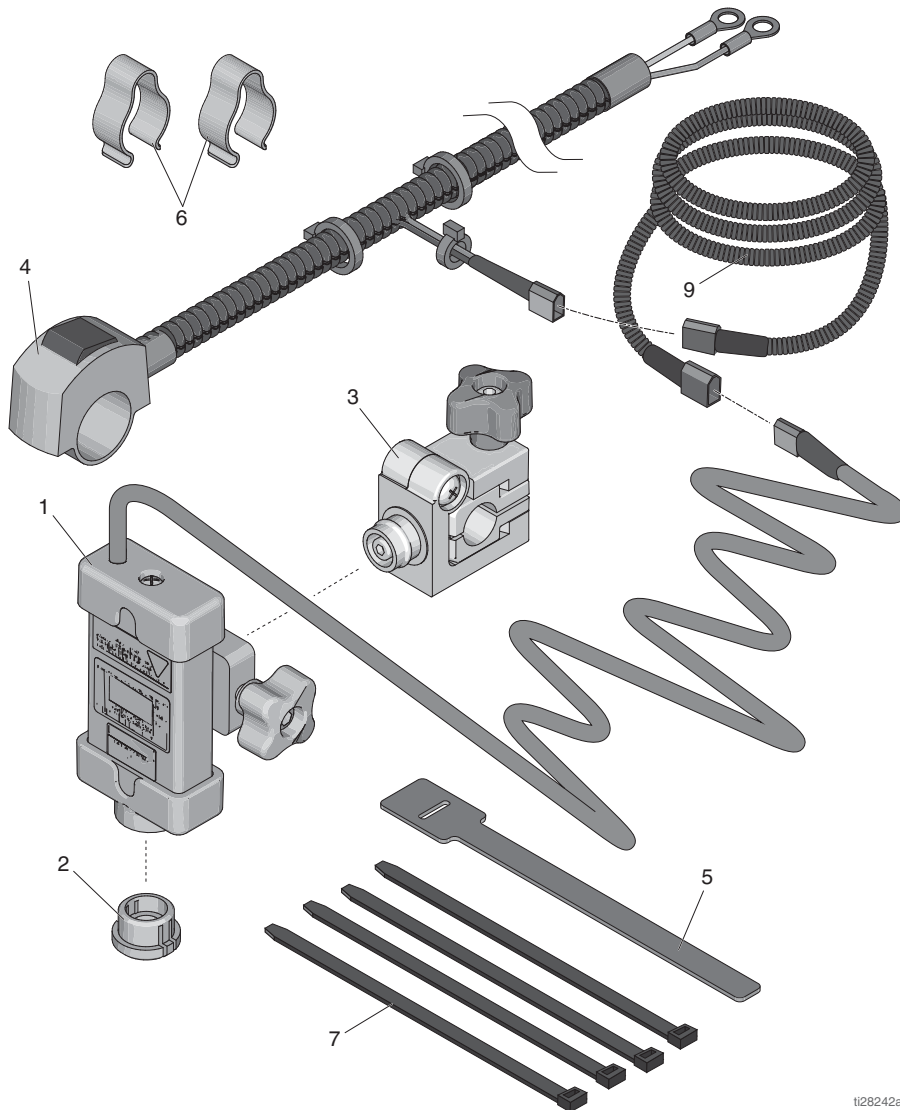

ti28242a

Ref	Part	Description	Qty	Ref	Part	Description	Qty
1	17H714	MODULE, laser, green dot	1	5	128854	STRAP, cable, velcro	1
	128857*	FUSE, blade, mini, 3 amp	1	6	178342	CLIP, spring	2
	128914	MANUAL, operations, laser	1	7	404989	TIE, strap	4
	128915	CARD, operator, laser	1	9	17H745	CONDUCTOR, electrical, jumper	1
	128916	LABEL, operations, laser light	1	*Series A kit only			
2	128917	SHIELD, paint, laser, assy.	1	Series A uses an external in-line fuse			
3	128865	BRACKET, mounting, laser, assy.	1	Series B uses an internal self-resetting fuse			
4	17H718	SWITCH, on/off, laser module	1				

Graco Standard Warranty

Graco warrants all equipment referenced in this document which is manufactured by Graco and bearing its name to be free from defects in material and workmanship on the date of sale to the original purchaser for use. With the exception of any special, extended, or limited warranty published by Graco, Graco will, for a period of twelve months from the date of sale, repair or replace any part of the equipment determined by Graco to be defective. This warranty applies only when the equipment is installed, operated and maintained in accordance with Graco's written recommendations.

This warranty does not cover, and Graco shall not be liable for general wear and tear, or any malfunction, damage or wear caused by faulty installation, misapplication, abrasion, corrosion, inadequate or improper maintenance, negligence, accident, tampering, or substitution of non-Graco component parts. Nor shall Graco be liable for malfunction, damage or wear caused by the incompatibility of Graco equipment with structures, accessories, equipment or materials not supplied by Graco, or the improper design, manufacture, installation, operation or maintenance of structures, accessories, equipment or materials not supplied by Graco.

This warranty is conditioned upon the prepaid return of the equipment claimed to be defective to an authorized Graco distributor for verification of the claimed defect. If the claimed defect is verified, Graco will repair or replace free of charge any defective parts. The equipment will be returned to the original purchaser transportation prepaid. If inspection of the equipment does not disclose any defect in material or workmanship, repairs will be made at a reasonable charge, which charges may include the costs of parts, labor, and transportation.

THIS WARRANTY IS EXCLUSIVE, AND IS IN LIEU OF ANY OTHER WARRANTIES, EXPRESS OR IMPLIED, INCLUDING BUT NOT LIMITED TO WARRANTY OF MERCHANTABILITY OR WARRANTY OF FITNESS FOR A PARTICULAR PURPOSE.

Graco's sole obligation and buyer's sole remedy for any breach of warranty shall be as set forth above. The buyer agrees that no other remedy (including, but not limited to, incidental or consequential damages for lost profits, lost sales, injury to person or property, or any other incidental or consequential loss) shall be available. Any action for breach of warranty must be brought within two (2) years of the date of sale.

GRACO MAKES NO WARRANTY, AND DISCLAIMS ALL IMPLIED WARRANTIES OF MERCHANTABILITY AND FITNESS FOR A PARTICULAR PURPOSE, IN CONNECTION WITH ACCESSORIES, EQUIPMENT, MATERIALS OR COMPONENTS SOLD BUT NOT MANUFACTURED BY GRACO. These items sold, but not manufactured by Graco (such as electric motors, switches, hose, etc.), are subject to the warranty, if any, of their manufacturer. Graco will provide purchaser with reasonable assistance in making any claim for breach of these warranties.

In no event will Graco be liable for indirect, incidental, special or consequential damages resulting from Graco supplying equipment hereunder, or the furnishing, performance, or use of any products or other goods sold hereto, whether due to a breach of contract, breach of warranty, the negligence of Graco, or otherwise.

Graco Information

For the latest information about Graco products, visit www.graco.com.

For patent information, see www.graco.com/patents.

TO PLACE AN ORDER, contact your Graco distributor or call 1-800-690-2894 to identify the nearest distributor.

*All written and visual data contained in this document reflects the latest product information available at the time of publication.
Graco reserves the right to make changes at any time without notice.*

Original instructions. This manual contains English. MM 3A3478

Graco Headquarters: Minneapolis

International Offices: Belgium, China, Japan, Korea

GRACO INC. AND SUBSIDIARIES • P.O. BOX 1441 • MINNEAPOLIS MN 55440-1441 • USA
Copyright 2016, Graco Inc. All Graco manufacturing locations are registered to ISO 9001.

www.graco.com

Revision B, March 2016